

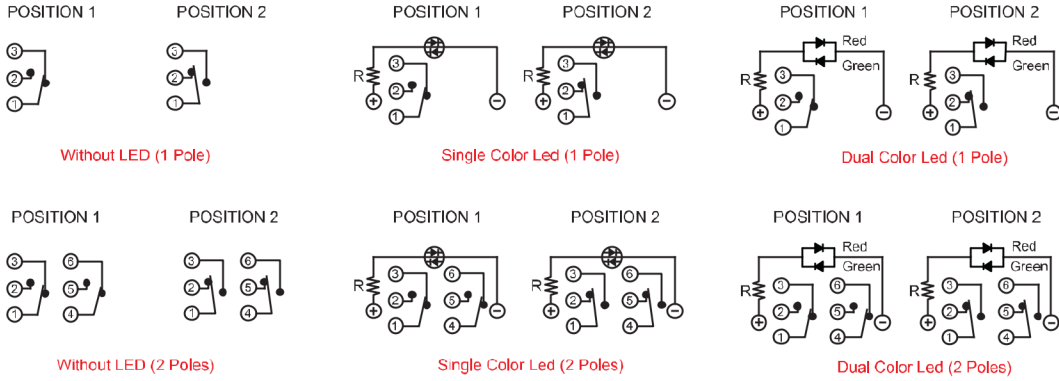

# MPB19 Series

19mm Metal Pushbutton Switches

## CIRCUIT



## BODY TYPE

MPB19  
Pushbutton Switches

**A0/B1/B2/C3** Body

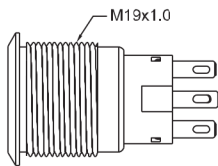

**D0/E1/E2/F3** Body (Flat)

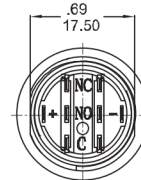
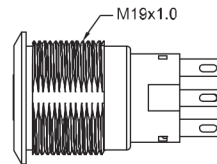
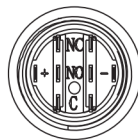

## BUTTON TYPE

**F** Flat Button

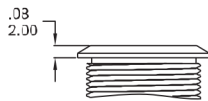

**H** High Button

\* Ring (Moveable) light type is inapplicable

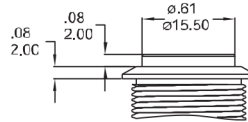

**R** Round Button

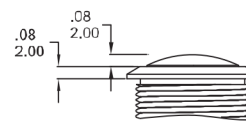

## LIGHT TYPE

**0** Without LED

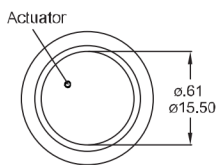

**R** Ring (Fixed)

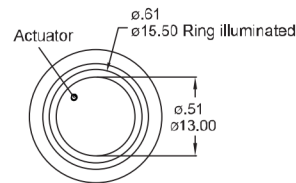

**D** Spot

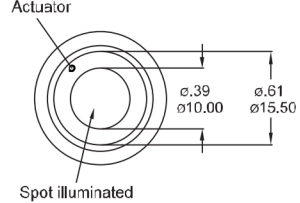

**E** Ring (Moveable)

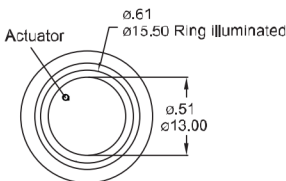

**P** Power logo

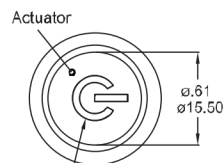

Power logo illuminated

\* Only for D0, E1, E2, F3 body.

**E1** Ring (Moveable)+Power logo

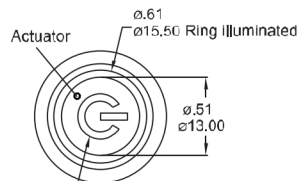

Power logo illuminated

\* E1 light type only for D0, E1, E2, F3 body.

\* Only for A0, B1, B2, C3 body.

# MPB19 Series

19mm Metal Pushbutton Switches

## FLAT BUTTON TYPE

**O** Without LED

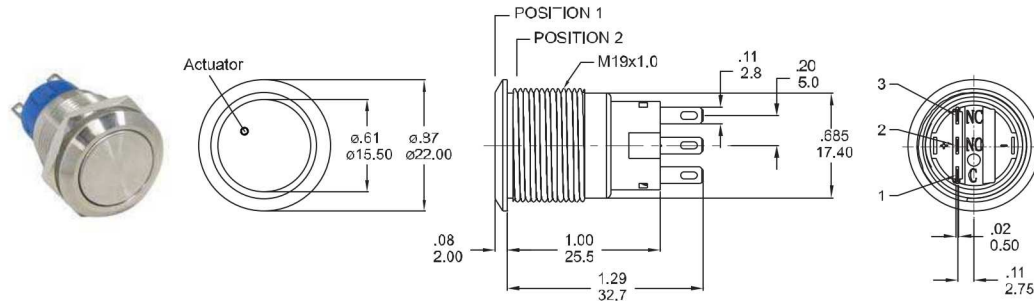

Part No. Shown : MPB19-A0F1□□-JQ

**R** Ring (Fixed)

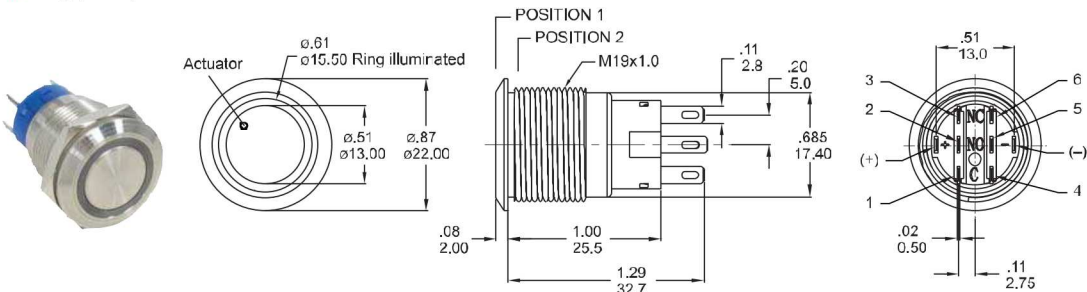

Part No. Shown : MPB19-A0F2□□-JQ

**D** Spot

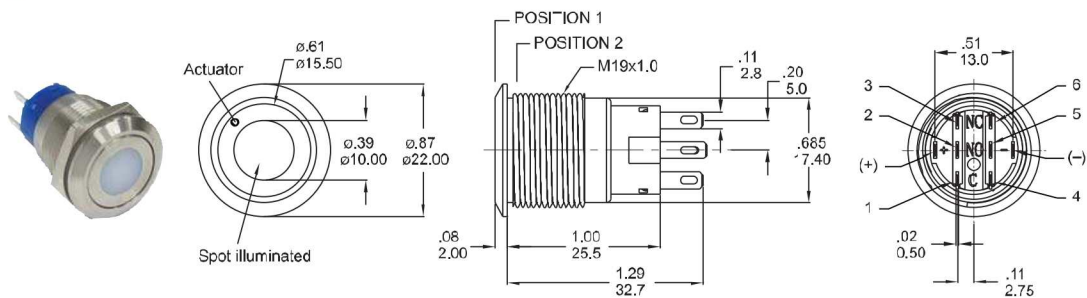

Part No. Shown : MPB19-A0F2□□-JQ

**E1** Ring (Moveable)+Power logo  
(Flat Button only)

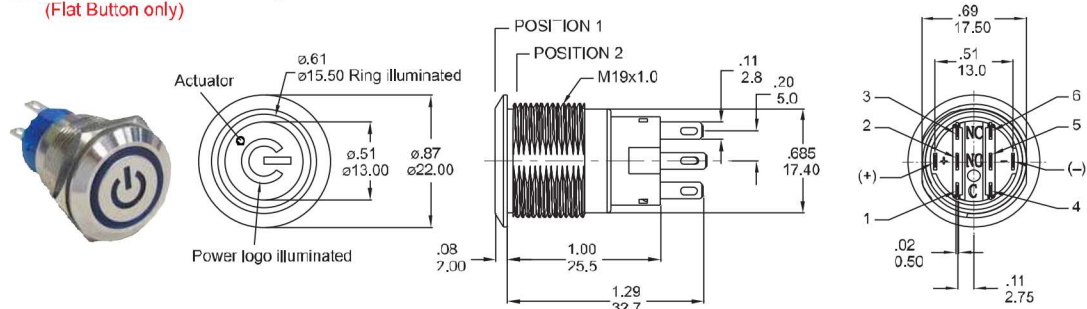

Part No. Shown : MPB19-D0F2□□-JQ

**MPB19**  
Pushbutton Switches

# MPB19 Series

19mm Metal Pushbutton Switches

## HIGH BUTTON TYPE

0 Without LED

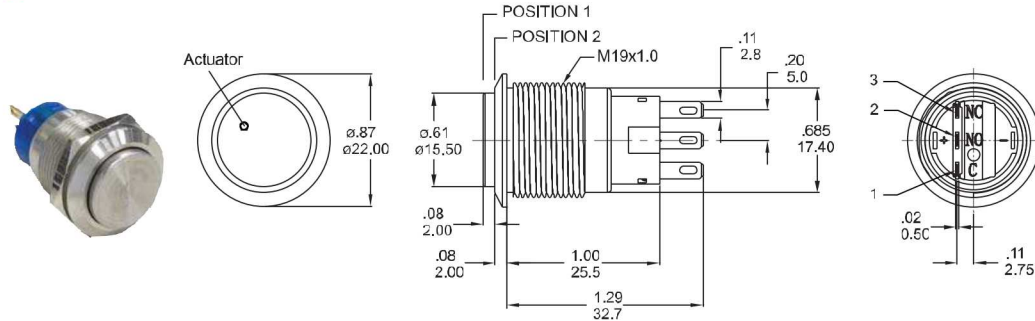

Part No. Shown : MPB19-A0H1 0-JQ

R Ring (Fixed)

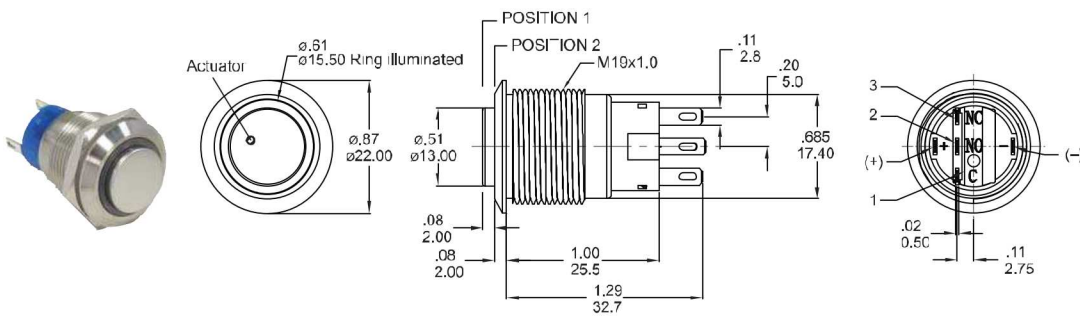

Part No. Shown : MPB19-A0H1 R-JQ

P Power logo

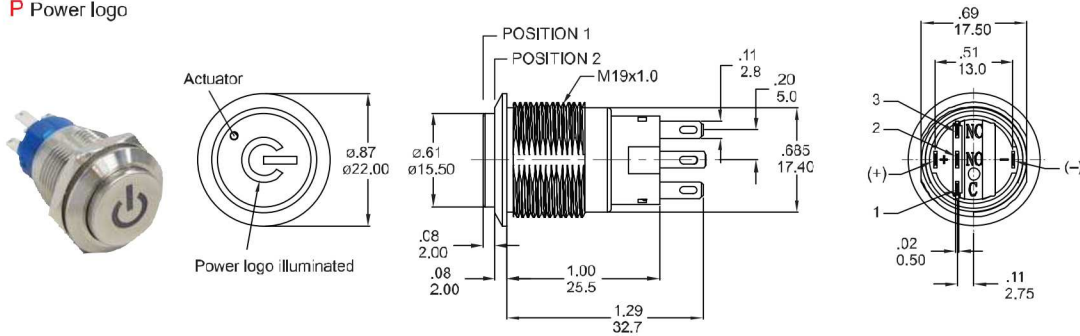

Part No. Shown : MPB19-D0H1 P-JQ

## ROUND BUTTON TYPE

0 Without LED only

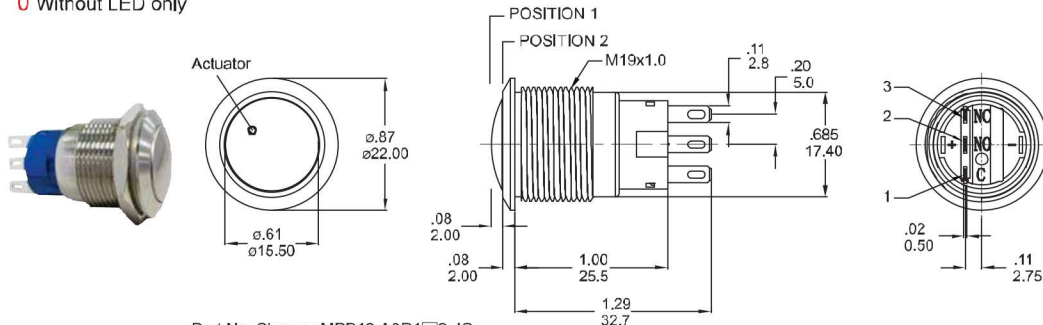

Part No. Shown : MPB19-A0R1 0-JQ

MPB19 Pushbutton Switches



# MPB19 Series

19mm Metal Pushbutton Switches

## TERMINAL TYPE

**J** Solder terminal (std)

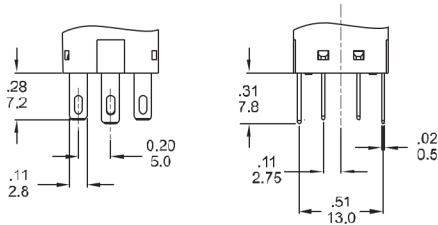

**S2** Short solder terminal

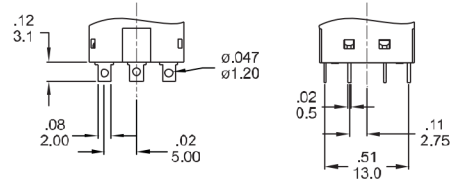

### Wire (Flying lead Terminals)

※ Wire=UL 3385,18AWG,300V(Black/Yellow/Green/Red/Purple)

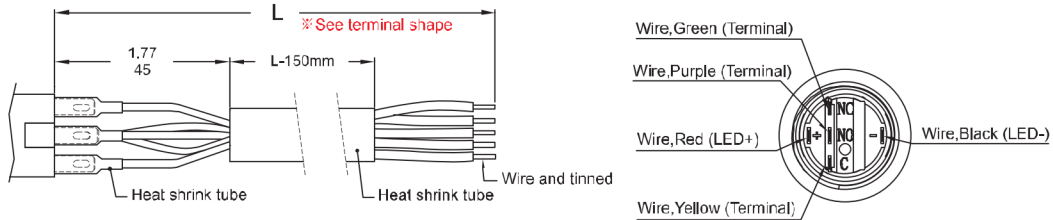

**O/R/D/E** Light Type

### PANEL MOUNTING

Max. Panel thickness: 10.0mm[.39]

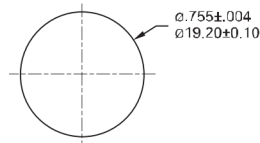

**P** Light Type

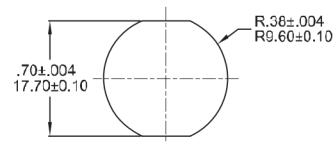

### ASSEMBLED VIEW

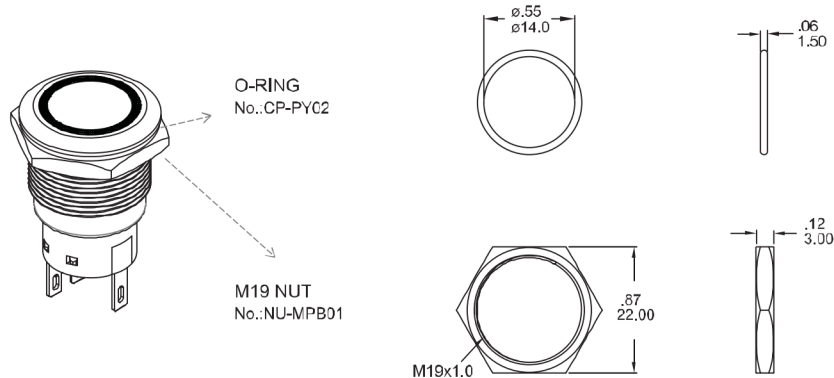

### O-RING INSTALLATION

Proposal	In front of the panel	Behind the panel
Installation Diagram		

**MPB19**  
Pushbutton Switches